

TYPICAL SINGLE RESIDENCE (S)

SINGLE WATER METER
REFER W.R.C. STD. DWGS
W-0090, & W-0092.

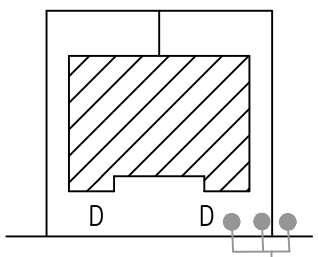

TYPICAL DUPLEX RESIDENCES (D)

DOUBLE WATER METER
REFER W.R.C. STD. DWGS
W-0090, & W-0092.

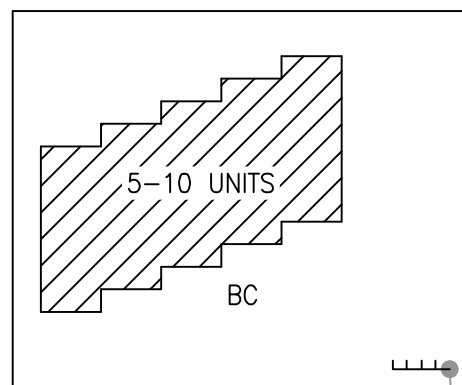

**TYPICAL MULTIPLE RESIDENCE
BODY CORPORATE (BC)**

MANIFOLDED WATER METER
REFER W.R.C. STD. DWGS
W-0095 & W-0096. (UP TO 10 UNITS)
A SECOND MANIFOLD CAN BE USED IF MORE THAN 10 UNITS & COMMON PROPERTY.

NOTES

1. If sub meters are not installed on the property boundary, they shall be required to have an approved method of having a digital readout position in the close vicinity of the master meter which shall be installed on the property boundary.
2. A detailed drawing is to be submitted of this installation showing conduit sizing and draw pits.
3. All cabling shall be multicore, plastic coated, with any joints below ground level being epoxy sealed.
4. Minimum depth of conduits shall be 500mm.
5. Cabling is not to be installed until all works are ready to be commissioned.
6. Cabling is to be installed and commissioned by an authorised person.

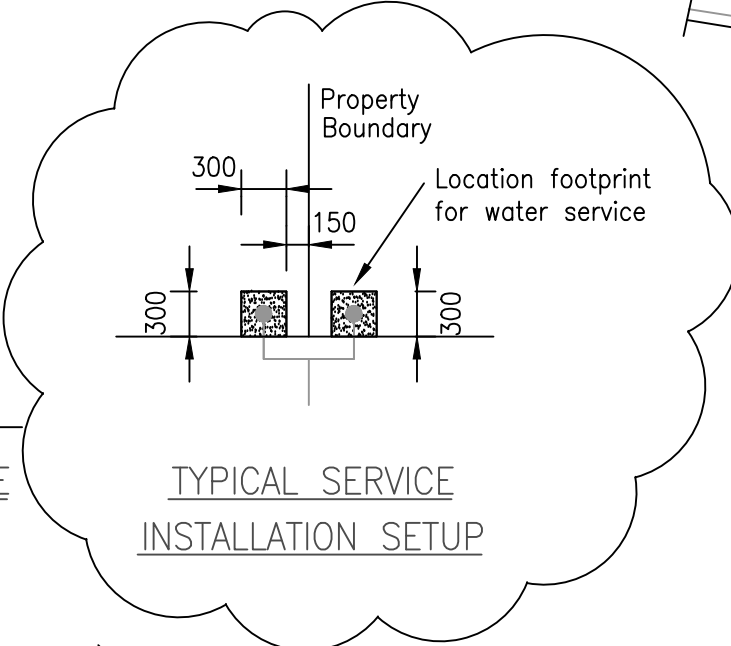

**TYPICAL SERVICE
INSTALLATION SETUP**

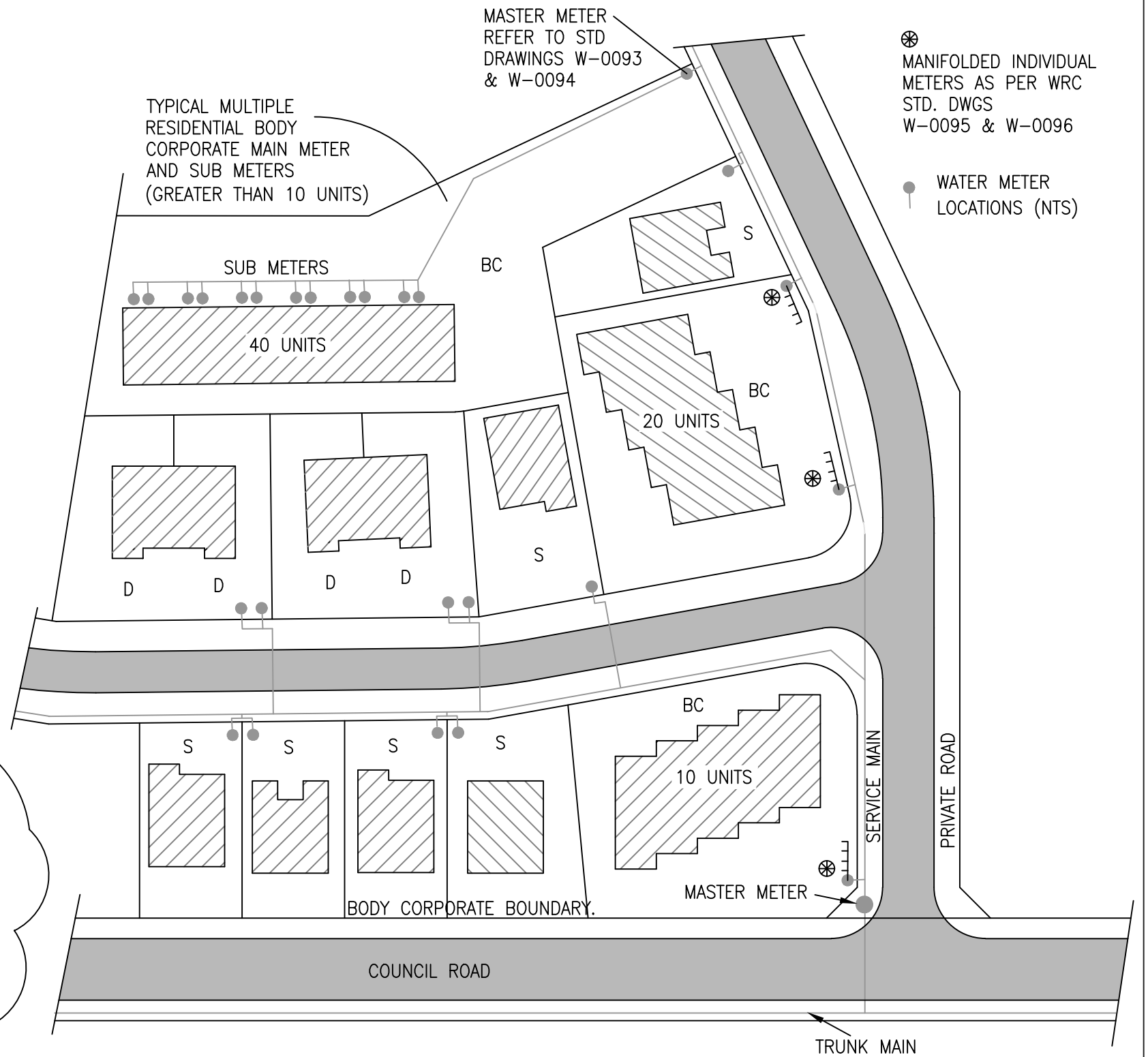

TYPICAL ALLOTMENT LAYOUT SHOWING STANDARD METER LOCATIONS FOR GATED OR UNGATED BODY CORPORATE COMMUNITIES GREATER THAN 20 INDIVIDUAL LOTS OR UNITS.

B	GENERAL UPDATES AND AMENDMENTS	26/09/18
A	ORIGINAL ISSUE	06/09
	REVISIONS	DATE



Email: info@whitsundayrc.qld.gov.au Web: www.whitsundayrc.qld.gov.au

BOWEN
67 Herbert St
Bowen 4805 Q
Ph 07 4761 3600

COLLINSVILLE
Cnr Stanley & Conway Sts
Collinsville 4804 Q
Ph 07 4785 5366

PROSERPINE
83-85 Main St
Proserpine 4800 Q
Ph 07 4945 0200

METER ARRANGEMENTS, LOCATIONS
AND ADDITIONAL DETAILS

WATER
Standard
Drawing
W-0097

A	B		
---	---	--	--